



# Dual Sensor Human Temperature Screening IP Camera

## Features

- Optical and thermal dual-sensor design for easy tracking of people and their temperature
- 384x288 thermal sensor for great measurement range
- Face detection to avoid false alerts due to mismeasurement on irrelevant objects
- Face recognition & comparison functions to identify blacklist or whitelisted people
- Support database up to 10,000 people
- Instant alerts on people with suspected fever or without wearing face mask
- Comprehensive reports with face captures, time and measured temperature of people



## Dimensions

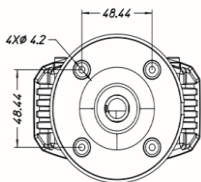
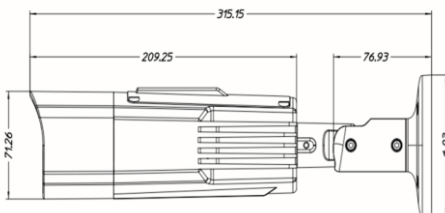

## Specifications

Model	MS2-B81M
<b>THERMAL CAMERA</b>	
Type	Uncooled VOx sensor
Effective Pixels	384 x 288
Pixel Size	17µm
Spectral Range	8 - 14µm
NETD	< 60mk (@25°C, F#=1.0, 300K, 50Hz)
Lens	9.1mm
Angle of View	Horizontal: 39°; Vertical: 30°
<b>VISIBLE CAMERA</b>	
Image Sensor	Sony 1/2.8" Starlight CMOS sensor
Effective Pixel	1920 (H) x 1080 (V)
Frame Rate	25/30fps
Resolution	Up to 1920 x 1080@25/30fps (main stream); Up to D1@25/30fps (sub stream);
Video Compression	H.265 / H.264 (16kbps – 8000kbps)
Audio Compression	G.711u (64Kbps)
Min. Illumination	0.0 lux (IR on), 0.01 lux@F1.4 (IR off)
IR Range	5m
Lens	6mm
Electronic Shutter	Auto / manual (1/5~1/100000)
S/N Ratio	≥50db (AGC off)
Video Adjustment	Brightness, contrast, saturation, sharpness, hue
3D Noise Reduction	Close / low / mid / mid-high / high
True WDR	Close / low / mid / high
Day / Night	Auto / color / B/W / external
<b>TEMPERATURE &amp; FACE MASK DETECTION</b>	
Temperature Measurement Range	30°C ~ 45°C
Temperature Measurement Accuracy	±0.3°C (with blackbody); ±0.5°C (no black body)
Detection Distance	2 – 5m (Suggest distance: 3m)
Simultaneous Detection	30 people (static), 10 people (in motion)
High Temperature Alarm	Support
Absent Face Mask Alarm	Support
Data Upload	Face captures, time, temperature and face mask status
<b>FACE RECOGNITION</b>	
Simultaneous Detections	30 people (static), 10 people (in motion)
Face Size	Pupils distance: ≥60 pixels; Face pixel: ≥80 pixels
Face Angle	Vertical: ≤20°; Horizontal: ≤30°
Capacity	10,000 faces
Accuracy	Capture rate ≥98%; Recognition rate ≥95% (subject to conditions)
<b>EVENT</b>	
Event Type	External alarm, video motion detection, video tamper, network interruption
Action Type	Dial-back, snapshot, relay switch control, FTP upload, email notification, micro SD card recording, flashing white light, audible message
Alarm Input	2
Motion Detection	4
Relay Output	1
<b>COMMUNICATION</b>	
Network	RJ-45, 100 base-T
Protocol	TCP/IP, HTTP, UDP, DHCP, RTSP, NTP, SMTP, DDNS, PPPoE, FTP, ONVIF
Open Standard	ONVIF (Profile S)
Concurrent Connection	2
Audio Input	1
Loudspeaker	1
RS485	1
Micro SD Card Slot	1 (up to 128Gb)
<b>MISCELLANEOUS</b>	
Operating Environment	-10 ~ 50°C (Thermometry temperature: 10-32°C)/ 90% relative humidity (no condensation)
Power Supply	DC12V / PoE, 10W
Dimensions (mm)	316 (W) x 49 (H) x 72 (D), excluding bracket
Weight	1.7kg



### WAMA Technology Limited

2205, Westley Square, 48 Hoi Yuen Road,  
Kwun Tong, Kowloon, Hong Kong.

Tel : (852) 3703 9260

Fax : (852) 3705 0053

Email : info@wamatech.co

Website : www.wamatech.co